

SLOT Y

LÁMINAS CONSTRUCTIVAS Y DECORATIVAS

CONSTRUCTIVE & DECORATIVE SHEETS



MODELOS ESPECIALES
SPECIAL PATTERNS

- 2.000 x 4.000mm **Trenzado / Braided**
1.000 x 6.000mm **Rejilla ventilación / Ventilation grille**
- 1-5mm **Trenzado / Braided**
1-2mm **Rejilla ventilación / Ventilation grille**
- Aluminio, Cobre, Acero inoxidable**
Aluminium, Copper, Stainless steel
- Corte, Curvado, Plegado, Perforado y Embutido**
Cutting, Curved, Folding, Perforated & Embossed

1T. T20/20

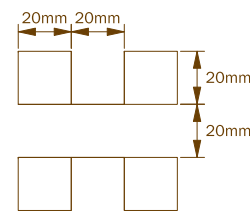

2T. T30/30

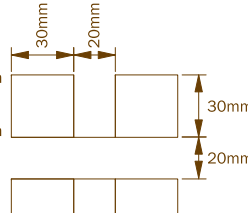

3T. T40/40

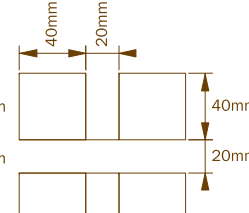

4T. T50/50

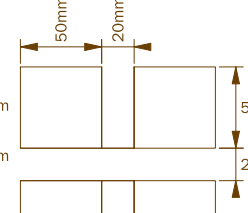

5T. T60/20

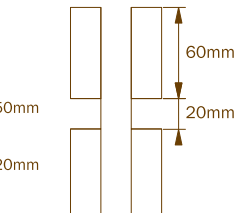

1V. RV50/12

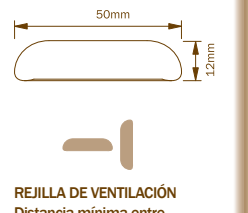

Distancia entre perforaciones: 20mm.
Distance between punches: 20mm.

No disponible en diagonal.
Not available in diagonal.

REJILLA DE VENTILACIÓN
Distancia mínima entre centros: \leftrightarrow 55mm \updownarrow 20mm
VENTILATION GRILLE
Minimum distance between centers: \leftrightarrow 55mm \updownarrow 20mm



MODELOS DE EMBUTICIONES
EMBOSSING PATTERNS

- 2.000 x 6.000mm
- 1-2mm
2-4mm (Composite de aluminio / Aluminium composite)
- Aluminio, Composite de aluminio, Cobre, Acero inoxidable, PVC**
Aluminium, Aluminium composite, Copper, Stainless steel, PVC
- Corte, Fresado, Curvado, Plegado, Perforado y Embutido**
Cutting, Milling, Curved, Folding, Perforated & Embossed

1E. R06

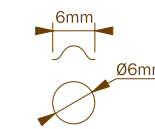

Distancia mínima entre centros: 35mm.
Minimum distance between centers: 35mm.

2E. R15

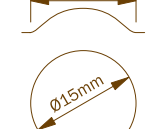

Distancia mínima entre centros: 40mm.
Minimum distance between centers: 40mm.

3E. R40

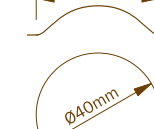

Distancia mínima entre centros: 60mm.
Minimum distance between centers: 60mm.

4E. R60

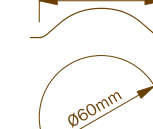

Distancia mínima entre centros: 90mm.
Minimum distance between centers: 90mm.

5E. C25

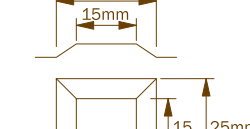

Distancia mínima entre centros: 50mm.
Minimum distance between centers: 50mm.

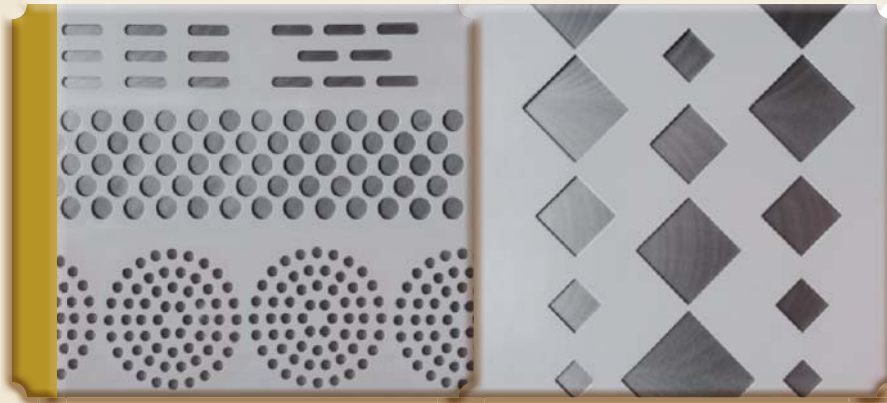

MODELOS DE PERFORACIONES
DRILLING PATTERNS

- 2.000 x 6.000mm
- 1-3mm
2-4mm (Composite de aluminio / Aluminium composite)
- Aluminio, Composite de aluminio, Cobre, Acero inoxidable, PVC**
Aluminium, Aluminium composite, Copper, Stainless steel, PVC
- Corte, Fresado, Curvado, Plegado, Perforado y Embutido**
Cutting, Milling, Curved, Folding, Perforated & Embossed

1P. C07/07

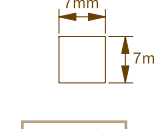

2P. C15/15

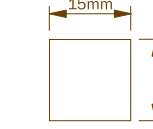

3P. C20/20

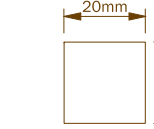

4P. C30/30

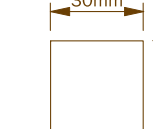

5P. C40/40

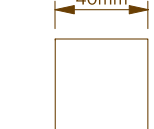

6P. C50/50

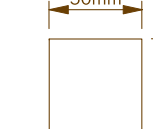

7P. RT20/04

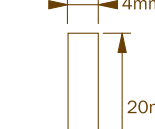

8P. RT60/20

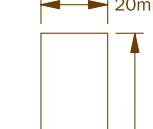

9P. RT80/05

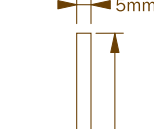

20P. C020/05

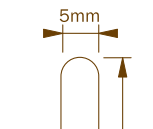

21P. C020/08

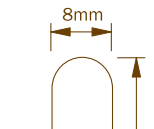

22P. C030/08

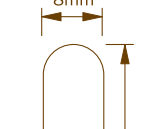

10P. RD02

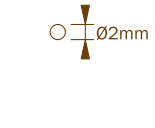

11P. RD03



12P. RD05



13P. RD06



14P. RD08

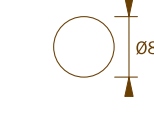

15P. RD10

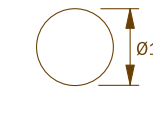

16P. RD22

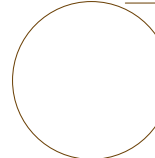

17P. RD24

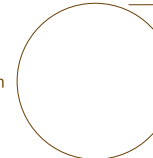

18P. RD40

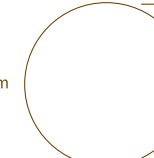

19P. RD50



SLOT Y son placas metálicas transformadas con golpe en seco (embuticiones) o perforadas con múltiples combinaciones según el efecto estético o arquitectónico deseado.

SLOT Y se basa en el uso de diferentes materiales que permiten una maleabilidad extra a la hora de practicar los diferentes efectos de acabado tales como perforaciones o embuticiones, sin que por ello pierdan sus cualidades de durabilidad o resistencia. Dentro de estos materiales el aluminio composite ofrece claras ventajas respecto al resto al poder usarse como elemento arquitectónico y aislante de gran rigidez y fácil mecanización.

Suave, seductora simplicidad de SLOT Y, el material que permite la máxima libertad constructiva y la expresividad decoradora más original y elocuente.

Los efectos de SLOT Y sobre materiales son muy variados en función del propio material, su espesor y el tipo de mecanizado aplicado; creando efectos sorprendentes que realzan el ambiente y lo convierten en una herramienta decorativa en alza.

SLOT Y reúne todas las condiciones para ser aplicado como elemento arquitectónico o decorador, integrándose o modelando cualquier tipo de superficie con sorprendentes resultados.

SLOT Y are metal plates transformed with blow dry (embossed) or perforated with multiple combinations depending on the desired architectural or aesthetic effect.

SLOT Y is based on the use of different materials to provide extra malleability when doing the different finishes such as perforations or dimples, without thereby losing its strength or durability qualities. Within these, the aluminium composite offers distinct advantages over the rest for being able to be used as an architectural element and insulating high rigidity and easy machining.

SLOT Y's seductive simplicity, softness, the construction material that allows maximum freedom and most original decorative expressiveness and eloquent).

SLOT Y's effects on materials are varied depending on the material, its thickness and the type of machining applied; creating stunning effects that enhance the environment and make it a decorative tool increasing.

SLOT Y meets all the conditions to be applied as an architectural element or decorator, by integrating or by modeling any surface with amazing results.

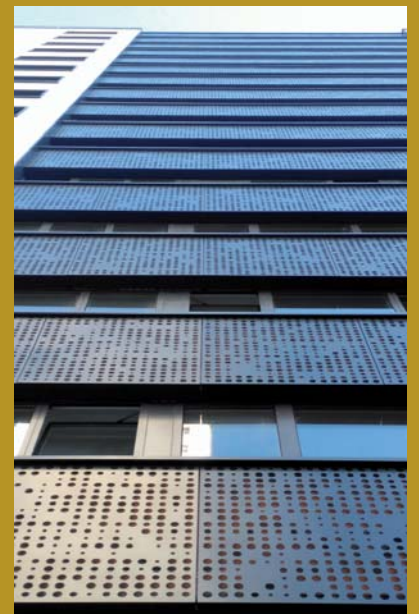
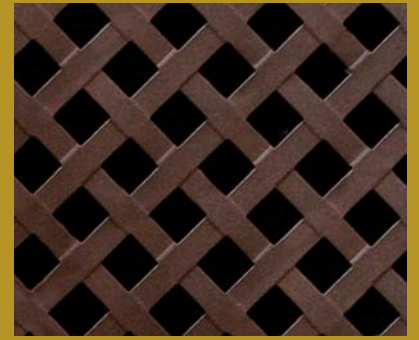

 GRUPOALUMISAN



 facebook/GrupoAlumisan
  @GrupoAlumisan
  +Grupo Alumisan
  alumisan.com



www.alumisan.com | informacion@alumisan.com
 T 0034 981 562 690 | F 0034 900 720 418

